

APPARITIONS	POA & POA	ATTENTION
	POA - 1780x1114 Agency job # 164164228 Product Description: Wuxia Sylva Support frame for wall hung toilet Brand: GoodHome Brand Contact: Jerry Kirby Number: 300002807064 - 0000 100% Vendor: Kingfisher - Direct Invoice Only Color Channels: CMYK (4) 30000000 Cutter Reference: 18853 - 1/4 - 1/4 1/4 1/4 1/4 Print Method: 1/4 GoodHome Colour Combination N/A	
THESE QUESTIONS MUST BE ANSWERED BEFORE THE NEXT STAGE: 1. RUSSIAN DO NOT DAT OFF ICON OMITTED AS PER RECENT INSTRUCTION. 2. RECYCLING INFORMATION AND UP CODES SETUP BASED ON DATA SHEET PLEASE CHECK AND CORRECT IF NECESSARY. 3. PLEASE CONFIRM THE BLAT AND LAYOUT OF FOR & ROP. 4. PLEASE CONFIRM DIMENSIONS FOR HEIGHT VALUE DATES IN PRO-100. 5. CONFIRM NR LOGO WE HAVE TAKEN FROM GEL, BUT DAT INFORMATION HAS AN EXTRA WORK INFORMATION.		
VENDOR/PRINTER NOTES 1. SETTING THE MAIN FUTURE DATE FOR THE RUSSIAN MARKET (yyyy) AND/OR WEB CODE (yyyy). 2. TO ADD THE DATA CODE YOU REQUIRE, USE THE 'yyyy/yyyy' AT YOUR POSITIONAL AND REPLACE WITH THE RELEVANT DETAILS. THIS IS CURRENTLY SET IN THE CUTTER MACHINE OCCASIONALLY NOT PRINT AND IS FOR OPTIONAL ONLY. TEXT NEEDS TO BE ON THE BARCODE COVER OF THE ARTWORK, IN BLACK AND SET TO COVERING. PLEASE NOTE: WHILE THIS ARTWORK HAS BEEN THOROUGHLY CHECKED BY SUN BRANDING SOLUTIONS IT IS THE CLIENT'S RESPONSIBILITY TO INSURE THAT ALL TEXT AND TRANSLATIONS ARE ACCURATE AND CORRECT. SUN BRANDING SOLUTIONS ACCEPT NO LIABILITY FOR INCORRECT TRANSLATIONS. PLEASE NOTE: NO USABLE CUTTER HAS BEEN SUPPLIED FOR THIS JOB. THE CUTTER HAS BEEN CREATED BY THE ARTWORK AGENCY AT ANYWORK STAGE. SUN BRANDING SOLUTIONS WILL NOT BE HELD ACCOUNTABLE FOR ANY COSTS THAT OCCUR DUE TO ERRORS OR ISSUES RELATING TO THE CUTTER CREATED. NOTE: THE GHT TEMPLATE USED ON TOP SELLING FACE IS C3 - STANDARD. NOTE: THE GHT TEMPLATE USED ON BOTTOM SELLING FACE IS C4 - AMENDED. NOTE: THE GHT TEMPLATE USED ON RIGHT SELLING FACE IS C6 - STANDARD.		

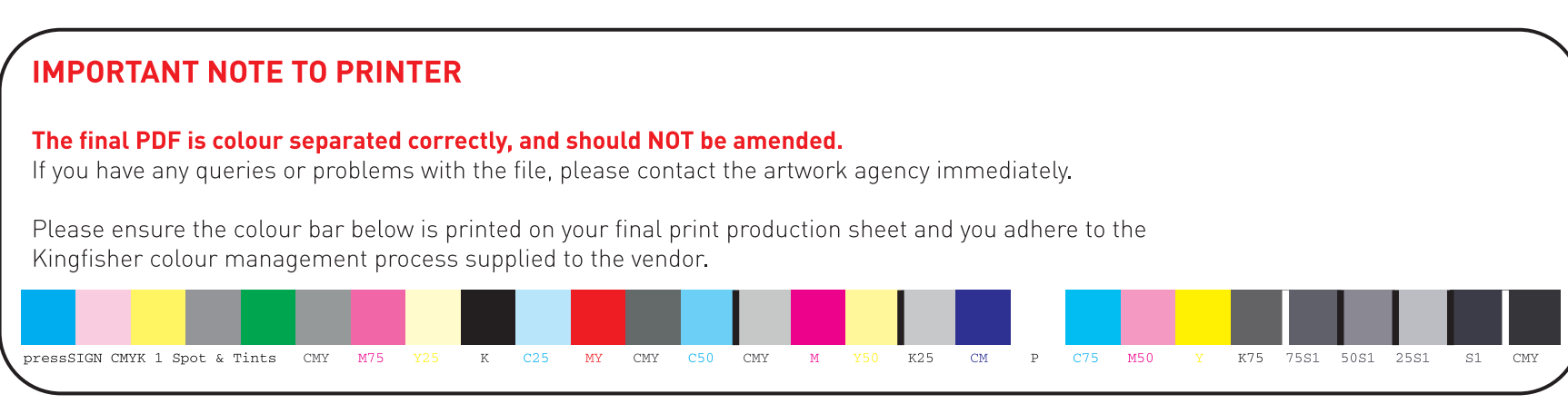

sylva

support frame for wall hung toilet

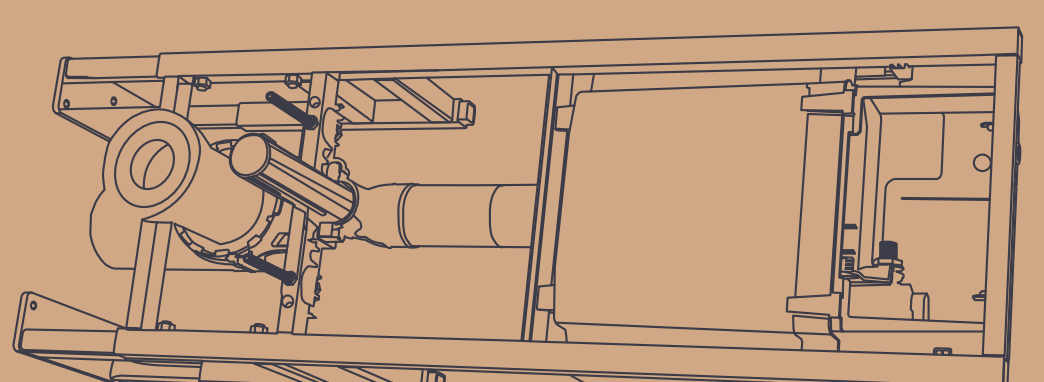
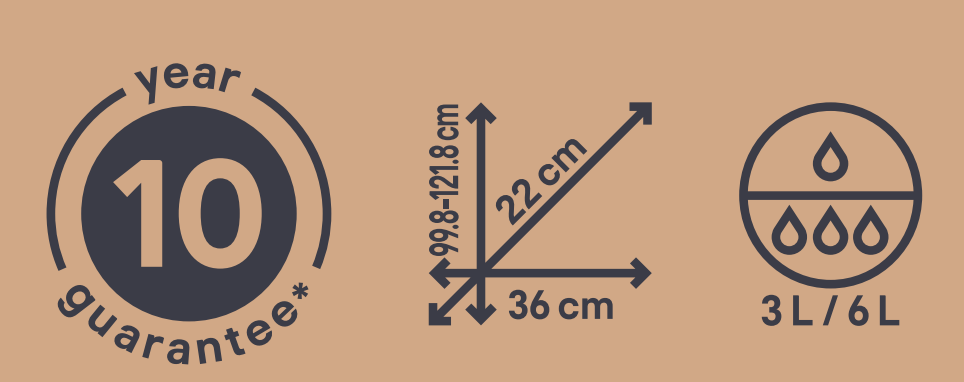

EN Handrail Frame: Dark grey coated steel, cast iron. Polystyrene, flush plate Chrome ABS matt. • Content: Frame, cast iron, flush plate and flange. Easy access to maintenance. Installation in concrete floor only. • Adjustable support frame (220 mm height adjustment) can be used for most plumbing applications. • Compatible with all hanging pipes. • Self assembly • Made in Romania • All figures are approximate.

FR Mainframe: Cadre: Acier emailé gris foncé. Réservoir: Polystyrène. Plaque de commande: ABS chromé mat. • Contenu: cadre, réservoir, plaque de commande et flange. Accès facile pour l'entretien. Installation sur sol béton ou encastré. • Cadre support réglable (220 mm de hauteur réglable) qui peut être utilisé pour l'installation des appareils de plomberie. • Compatible avec toutes les canalisations suspendues. • À assembler soi-même. • Fabriqué en Roumanie.

PL Mainframe: Szkielet: Stal powlekana w kolorze ciemnoszarym. Zbiornik: pianka polistyrenowa. Przycisk spłukujący: Chromowana płytka matowa. • Zawartość zestawu: Szkielet, zbiornik na wodę, przycisk spłukujący, elementy przyłączeniowe. Łatwy dostęp do obsługi wnętrza. • Ramka regulowana na wysokość (220 mm) - regulowany element montażowy regulacji wysokości w zakresie 220 mm. • Łatwa instalacja w betonowej podłodze lub w otworze w ścianie. • Kompatybilność z wszystkimi typami instalacji podwieszanych. • Łatwa instalacja. • Wyprodukowano w Rumunii. Wszystkie dane są przybliżone.

DE Handrail: Rahmen: Dunkelgrau beschichteter Stahl. Behälter: Polystyrol. Bedienungsplatte: Chromierte Matte ABS Chrom. • Inhalt: Rahmen, Behälter, Bedienungsplatte und Flansch. • Leichter Zugriff für Wartungsarbeiten. • Installation nur auf Betonboden. • Verstellbarer Stützrahmen (220 mm Höhenverstellung) kann für die meisten Sanitäranschlüsse verwendet werden. • Kompatibel mit allen hängenden Schläuchen. • Selbstmontage. • hergestellt in Rumänien. • Alle Werte sind ca. Angaben.

RUS Поддержка: Каркас: Сталь с темносерым покрытием. Резервуар: пенополистирол. Элементы присоединения: хромированная пластина матовая. • Содержание набора: АСС-элементы, хромированный резервуар, хромированная пластина, элементы присоединения. • Легкий доступ к внутреннему пространству. • Регулируемая монтажная рама (высотой в пределах 220 мм). • Легкая установка в бетонную полость или регулировка высоты монтажа. • Совместимость с любыми типами подвешенных установок. • Легкая установка. • Произведено в Румынии. Все данные являются приблизительными.

RO Mainframe: Cadru: Oțel vopsit griu închis. Rezervor: polistiren. Placă de comandă: ABS cromat. • Conținut: cadru, rezervor, placă de comandă și flanșaj. • Acces ușor pentru întreținere. • Instalare numai în beton. • Cadru reglabil de susținere înălțime (220 mm) poate fi utilizat pentru majoritatea aplicațiilor. • Compatibil cu toate vasele de bătăi montate pe perete. • Instalare ușoară. • Fabricat în România. Toate valorile numerice sunt aproximative.

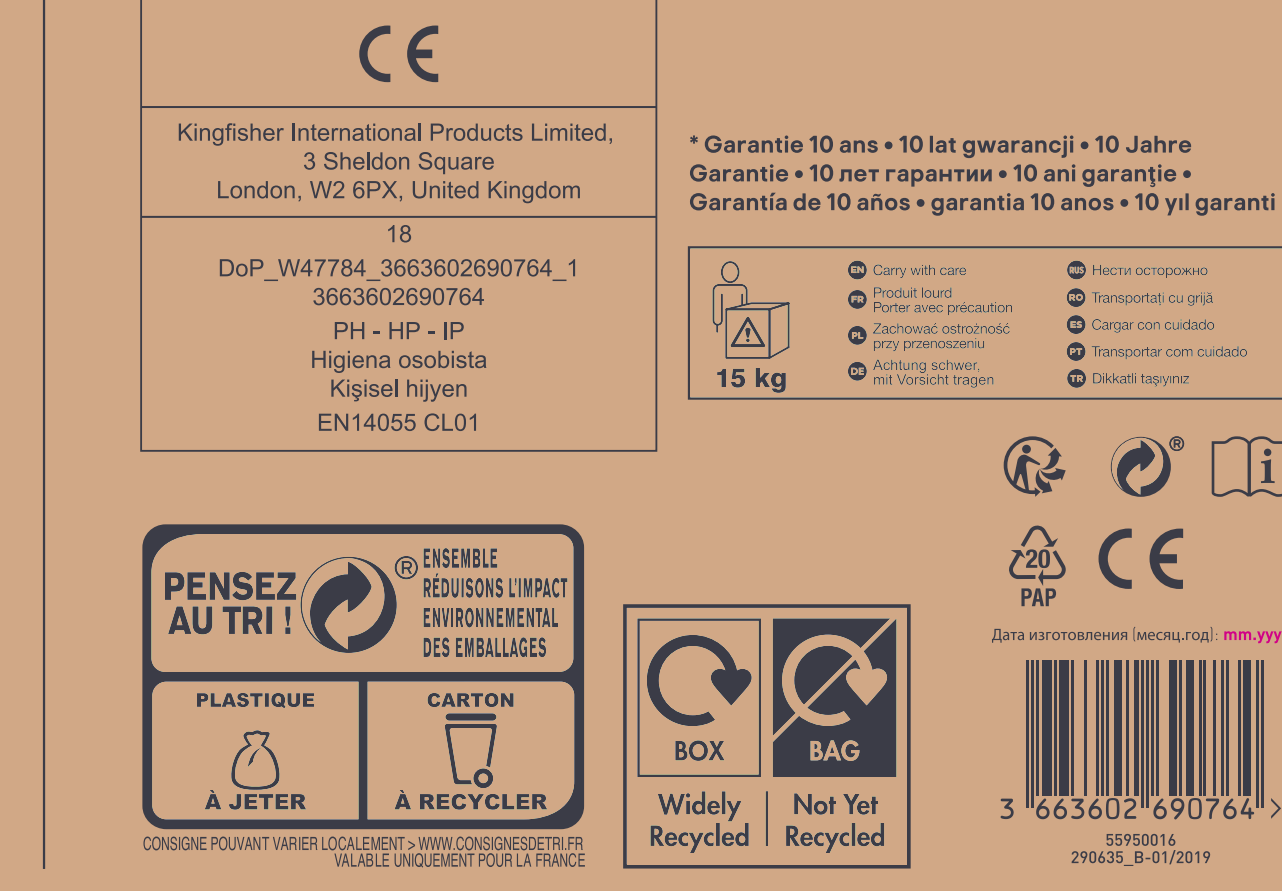
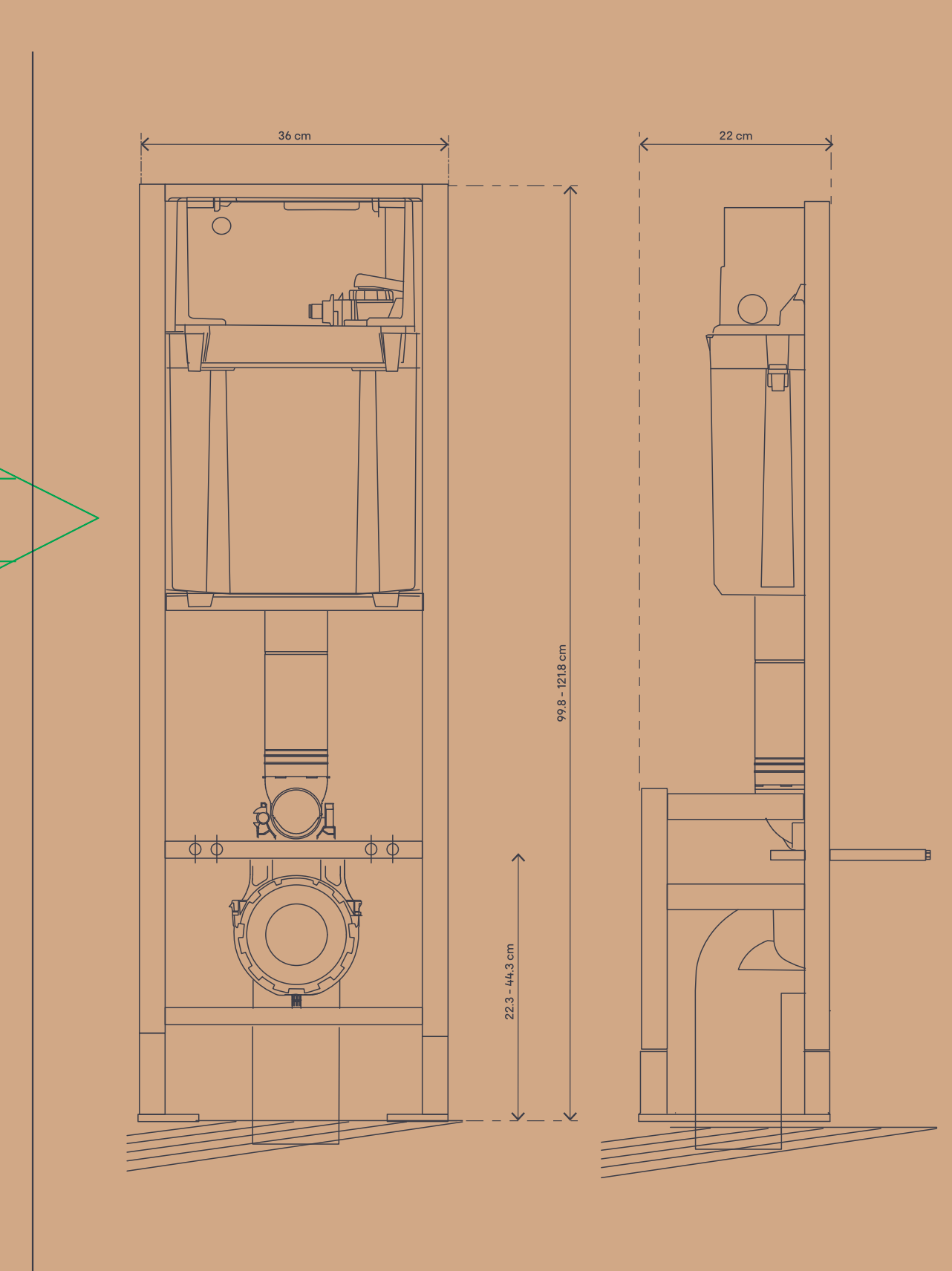

sylva

support frame for wall hung toilet

Bâti pour WC suspendu
Stelaż podtynkowy do miski WC
Stützrahmen für wandmontierte Toilette
Инсталляция для подвесного унитаза

Cadru pentru rezervoare WC incastrate
Estructura de soporte para inodoro suspendido
Estrutura de suporte para sanita suspensa
Asma klozet için destek çerçevesi

